

# How to connect Ion Station to a Smartphone



*Note. If you already have Smart Life App installed, you can skip this step:*

1. Install Smart Life App from App Store or Google Play:

A screenshot of the Google Play Store page for the 'Smart Life - Smart Living' app. The app is by Volcano Technology Limited, categorized as Lifestyle, with a 4.5-star rating and 42,544 reviews. It is suitable for 'Everyone'. A message states 'You don't have any devices'. There is an 'Add to Wishlist' button and a green 'Install' button. Below the app card are four promotional images: 1. 'Smart Control Smart life' showing a temperature control interface. 2. 'Create your own intelligent scenarios' showing a scene with a temperature of 50. 3. 'Enjoy the together wit' showing a social sharing interface. 4. A partial view of the app's main dashboard. At the bottom, a description reads: 'Smart Life is a smart device management App for you to control and manage your intelligent home products easier and to live smarter.'

2. Add new device:

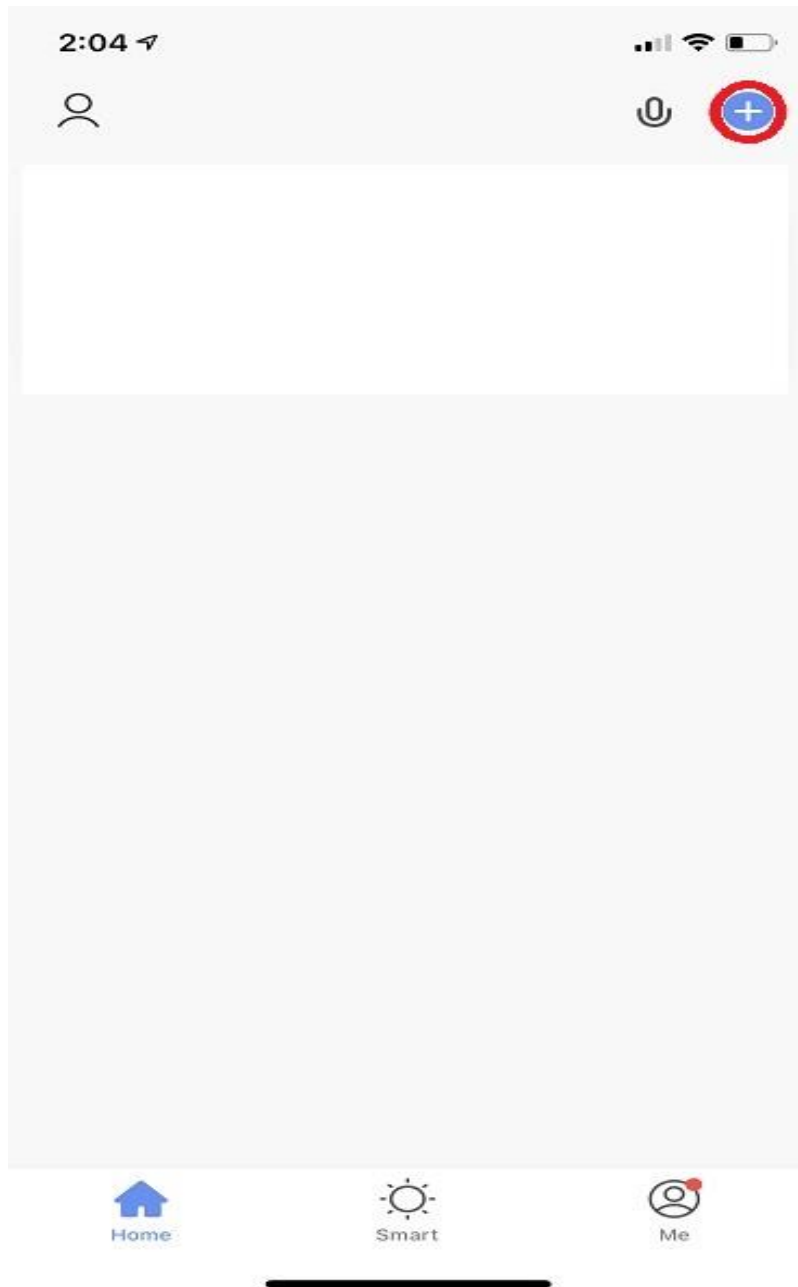

### 3. Choose your device from the list:

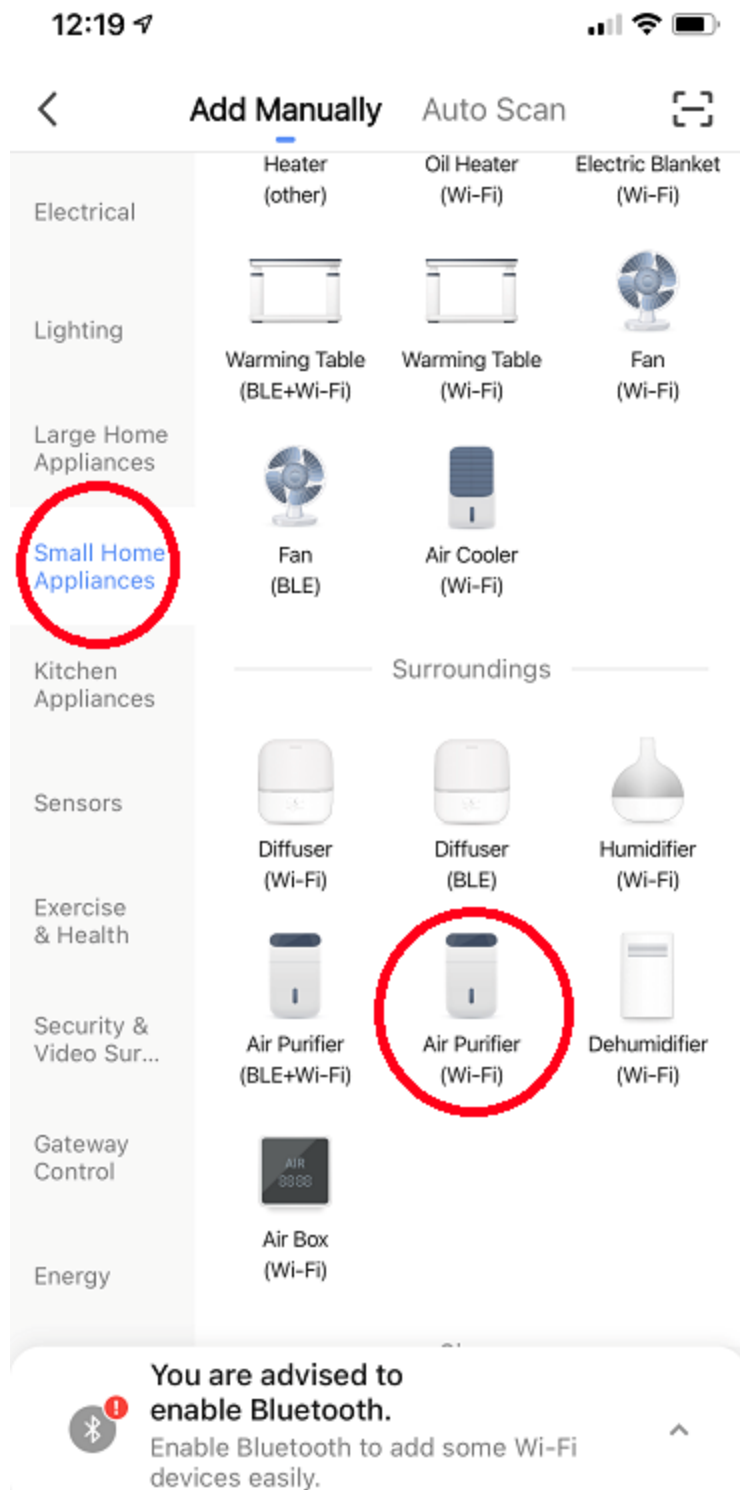

4. Enter your Wi-Fi Network Name and Password:

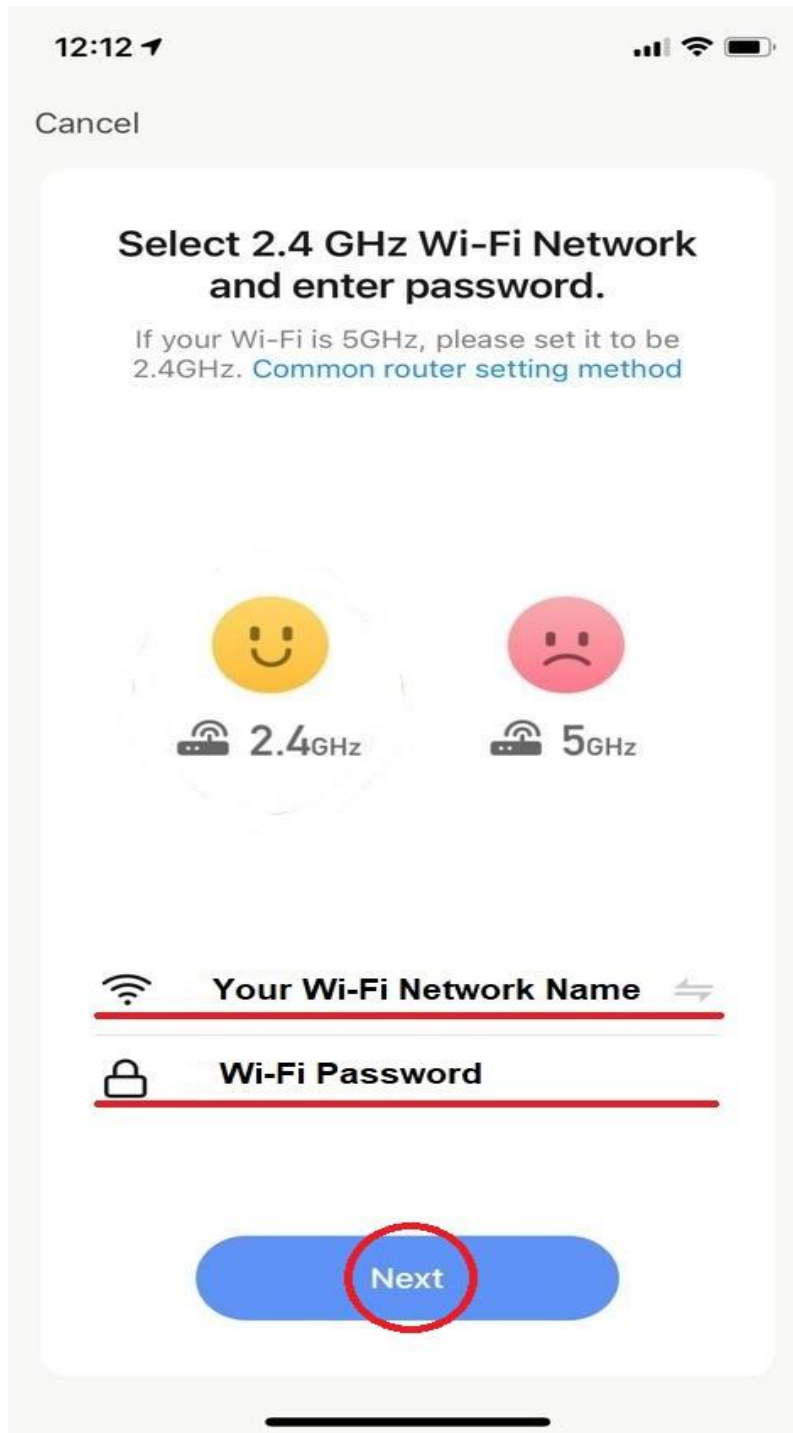

5. In the standby mode keep pressing “Ionizer” button for 5 seconds until the Wi-Fi indicator light flashing quickly:



6. Make confirmation:

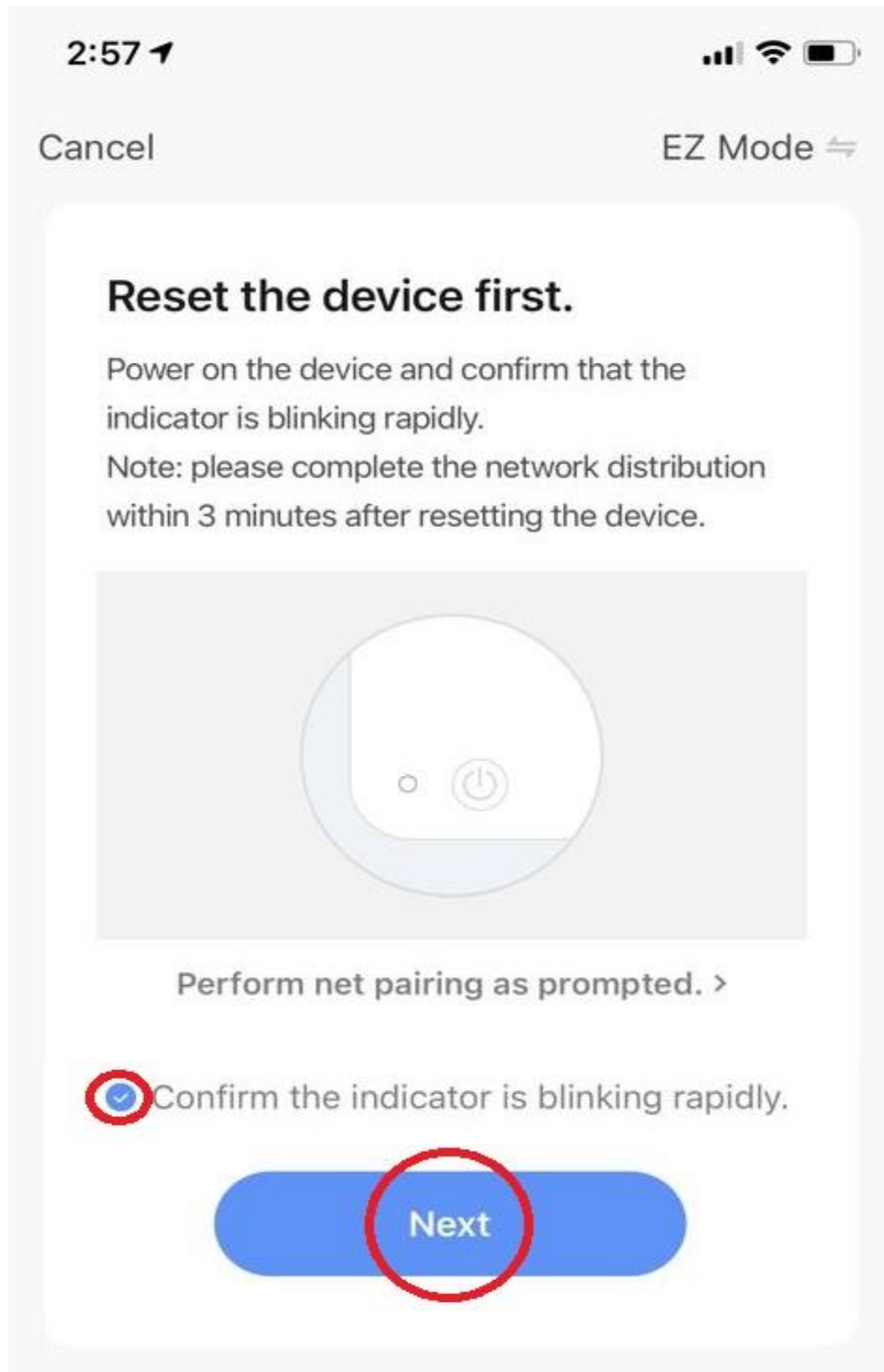

7. Wait for the three-step automatic connection:

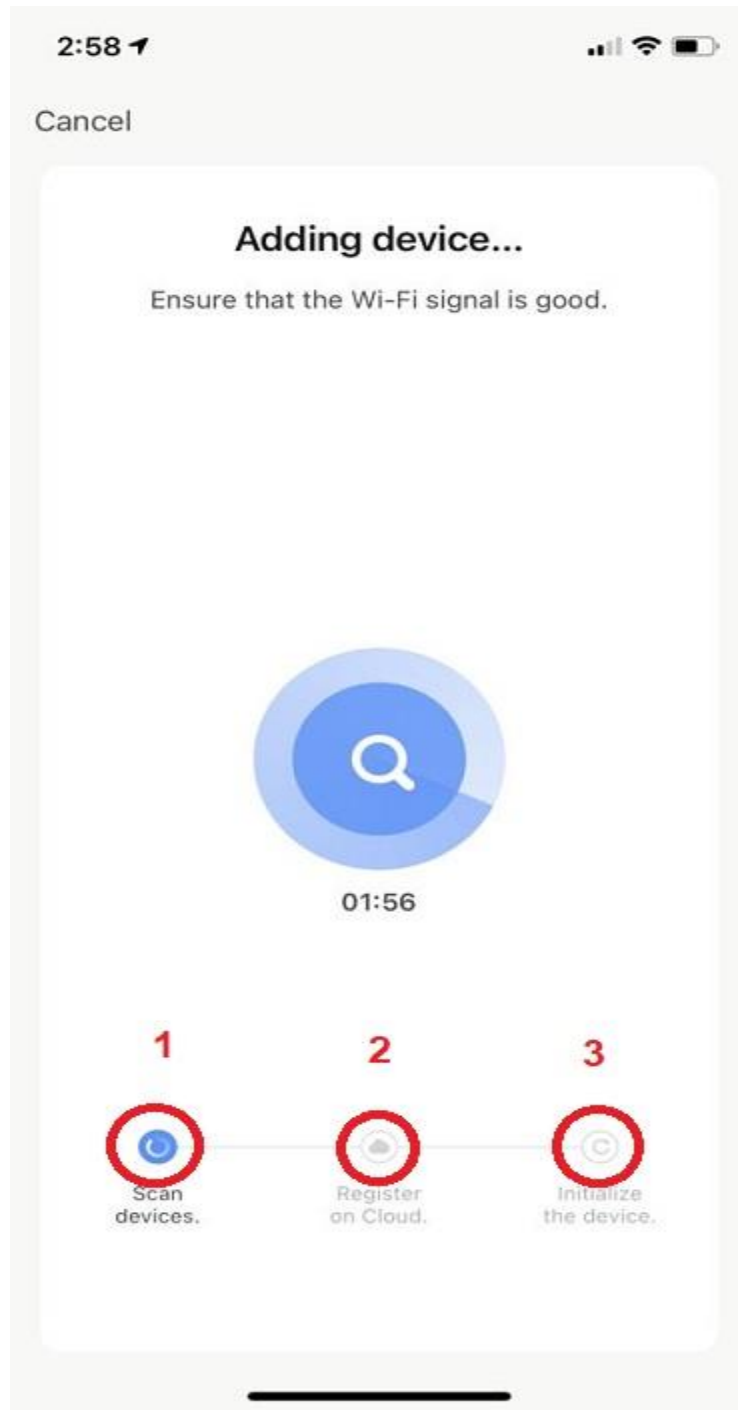

8. The final step. If your device is added, you will see:

12:31 ↗



Done

Added.



Ion Station ✎

Device added successfully





9. After that, you can see all the information in your smartphone and remotely control the device:

